

£565,000

Hayling Rise

Worthing, BN13 3AQ

PROPERTY SUMMARY

Nestled in the desirable area of Hayling Rise, High Salvington, Worthing, this charming detached bungalow presents an excellent opportunity for those seeking to put their own stamp on a property that has great potential. With two well-proportioned reception rooms, this property offers ample space for relaxation and entertaining.

Set on a generous corner plot, the bungalow boasts a large south-facing garden, perfect for enjoying sunny days and outdoor gatherings. The expansive garden offers plenty of potential for gardening enthusiasts or those wishing to create their own outdoor oasis. Additionally, the property features a large garage and off-street parking.

Being chain-free, this bungalow is ready for immediate occupancy, allowing for a smooth transition into your new home. The sought-after location of High Salvington adds to the appeal, with its friendly community and proximity to local amenities. This property is ideal for first-time buyers, downsizers, or anyone looking to invest in a home with great potential.

In summary, this delightful bungalow combines comfort, space, and a prime location, making it a must-see for anyone in search of their next home. Don't miss the chance to explore the possibilities this property has to offer.

2



1



2









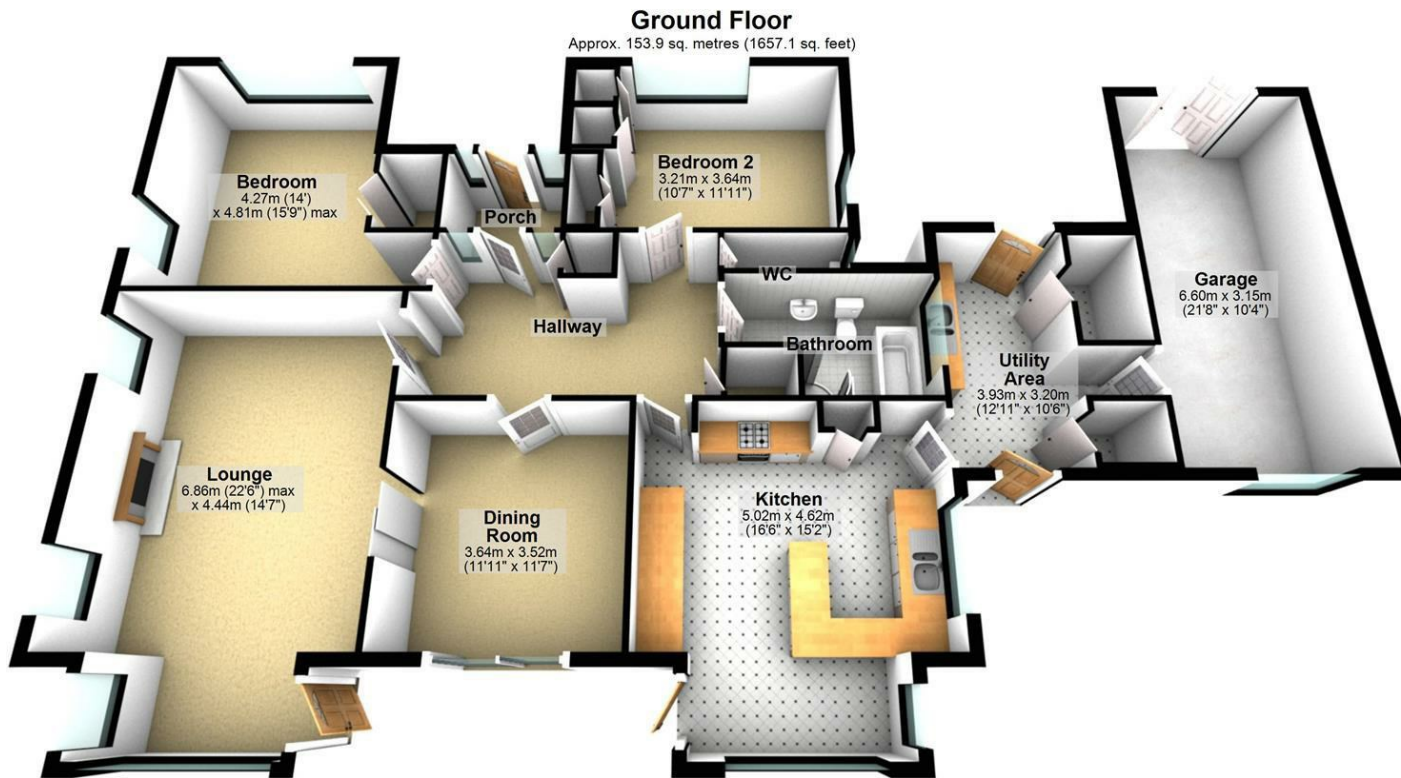

Total area: approx. 153.9 sq. metres (1657.1 sq. feet)

LOCAL AUTHORITY

TENURE
Freehold

COUNCIL TAX BAND
F

VIEWINGS
By prior appointment only



Energy Efficiency Rating		
	Current	Potential
Very energy efficient - lower running costs		
(92 plus) A		
(81-91) B		
(69-80) C		
(55-68) D	64	76
(39-54) E		
(21-38) F		
(1-20) G		
Not energy efficient - higher running costs		
England & Wales	EU Directive 2002/91/EC	

Agents Note: Whilst every care has been taken to prepare these particulars, they are for guidance purposes only. All measurements are approximate and are for general guidance purposes only and whilst every care has been taken to ensure their accuracy, they should not be relied upon and potential buyers/tenants are advised to recheck the measurements



OFFICE ADDRESS
22 South Farm Road
Worthing
West Sussex
BN14 7AA

OFFICE DETAILS
01903 532225
worthing@localagent.co.uk
www.openhouseworthing.co.uk